

Installation instructions

AGI 100-2 series

AGI 104-2

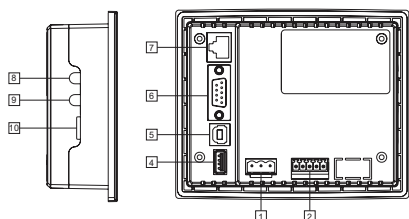

AGI 107-2

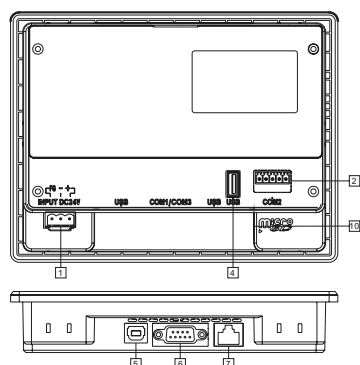

AGI 110-2

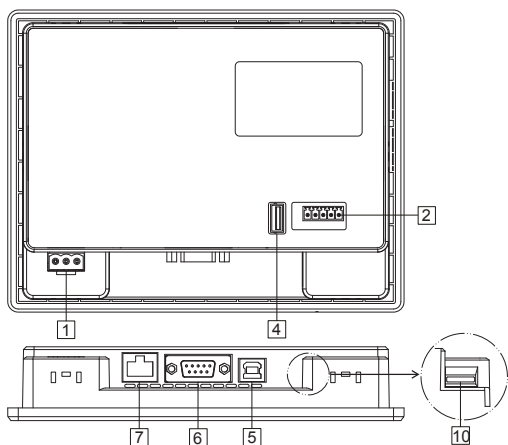

AGI 115-2

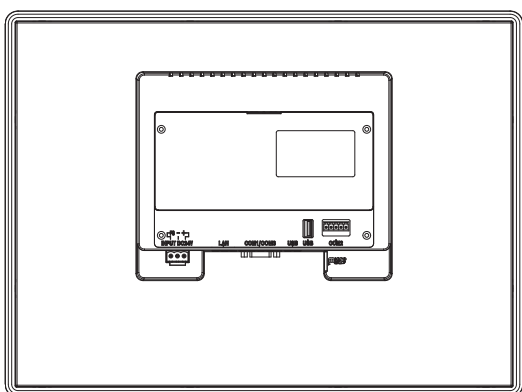

Outlet

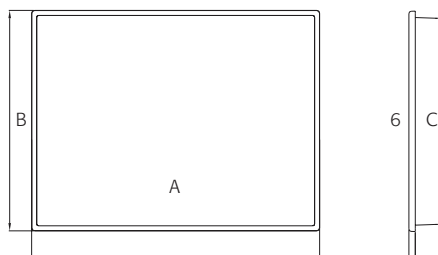

Cutout



Model	A	B	C	L	H
AGI 104-2	130mm 5.11"	106.2mm 4.18"	37mm 1.46"	118.5mm 4.66"	92.5mm 3.64"
AGI 107-2	188mm 7.4"	143.3mm 5.64"	30mm 1.18"	175mm 6.88"	132.5mm 5.21"
AGI 110-2	269.8mm 10.62"	212mm 8.35"	38mm 1.5"	258.5mm 10.19"	200.8mm 7.91"
AGI 115-2	399.1mm 15.73"	297.6mm 11.73"	62.6mm 2.14"	384.5mm 15.15"	283mm 11.15"

1

3

Document no.: 4189340817A

Ports & connections

- | | |
|--------------------------|----------------------------------|
| 1 Power connector (jack) | 7 Ethernet port |
| 2 Com2 5pin (terminal) | 8 Audio external module (option) |
| 4 USB connector | 9 Mic external module (option) |
| 5 USB client | 10 Micro SD slot/Micro SD |
| 6 COM1 9Pin Female | |

Panel fixing

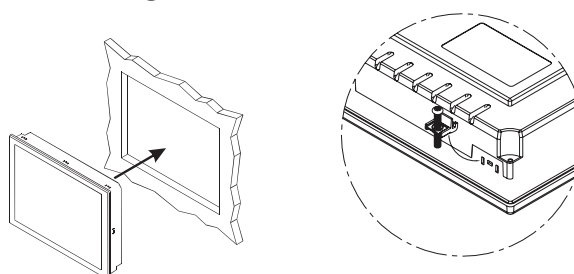

Fixing screw

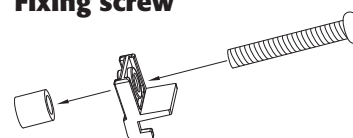

Screw each fixing screw until the bezel corner is in contact with the panel.

2

4

Power supply

Document no.: 4189340817A



Powered by a low voltage/limited energy power source.

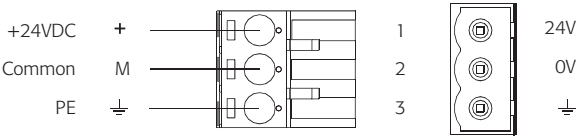

To avoid electrical shock, do not open the rear cover of the panel when power is applied.



Ensure that the power supply has enough power capacity for the operation of the equipment.

Models	Power consumption
AGI 104-2	24V DC $\pm 17\%$: 5W
AGI 107-2	24V DC $\pm 17\%$: 10W
AGI 110-2	24V DC $\pm 17\%$: 25W
AGI 115-2	24V DC $\pm 17\%$: 25W

5

Download cable

Document no.: 4189340817A

Com1

Com1 Connector 9Pin Male	PC Connector 9Pin Female
RXD 2	3 TXD
TXD 3	2 RXD
SG 5	5 SG
(RS-232)TXD(COM3) 7	2 RXD
(RS-232)RXD(COM3) 8	3 TXD

Connections

Com1 (DB-9-Female)	
PIN	Description
1	RD-422 TXD+/RS-485+
2	RS-232 RXD
3	RS-232 TXD
4	RS-422 RXD+
5	GND
6	RS-422 TXD-/RS-485-
7	RS-232 TXD
8	RS-232 RXD
9	RS-422 RXD-

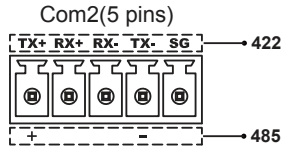

6

Battery recycling

Document no.: 4189340817A

Battery

MATSUSHITA/
PANASONIC 3V 50mAh
Vanadium Lithium
Rechargeable Battery
type VL2330/1HF



Recycle batteries according to local regulations.



7

Document no.: 4189340817A

The products have been designed for use in an industrial environment in compliance with the 2004/108/CE directive and in compliance with the following IEC standards:

EN 61000-6-4	EN 55011 Class A
EN 61000-6-2	EN 61000-4-2
	EN 61000-4-3
	EN 61000-4-4
	EN 61000-4-5
	EN 61000-4-6
	EN 61000-4-8
	EN 61000-4-11

Beware that installing these products in residential, commercial and light-industrial environments is only allowed after special measures have been implemented to comply with the IEC-61000-6-3 approval regarding Electromagnetic compatibility and Generic emission standards.

Reproduction of the contents of this copyrighted document, in whole or in part, is prohibited without written permission from DEIF A/S.

DEIF reserves the right to change any of the above.



-power in control-

DEIF A/S · Frisenborgvej 33 · DK-7800 Skive
Tel.: +45 9614 9614 · Fax: +45 9614 9615
info@deif.com · www.deif.com



Because of continued development, we reserve the right to supply equipment which may vary from the above.

